



Ku-Band Harmonic Lowpass Filter

Model 16370

This compact transmit filter is designed to suppress the 2nd harmonic frequency range of the Ku-Band.

Specifications:

Passband:	13.75 - 14.50 GHz
Insertion Loss:	0.25 dB Typ
VSWR:	1.2:1 Max
Reject Band:	27.5 - 29.0 GHz
Rejection:	50 dB Min, 60 dB Typ
Power:	200 Watts
Flanges:	WR75 Cover
Weight:	0.14 lbs (0.06 Kg)
Dimensions:	2.19" x 1.5" x 1.5" (51mm x 38mm x 38mm)
Finish:	Gray Lacquer

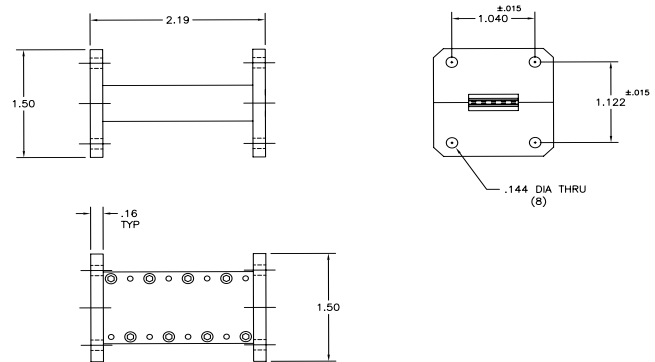

MICROWAVE FILTER CO., INC.
6743 KINNE STREET, E. SYRACUSE, NY 13057
E-Mail: mfcsales@microwavefilter.com

800-448-1666 • 315-438-4700
Web: www.microwavefilter.com